

Project Brochure

Let's Build Halima Children's Home
and rescue orphans and street children in Moshi, Tanzania

kijana-kwanza.org/halima



About Kijana Kwanza (Young People First)

Founded in 2019, Kijana Kwanza supports the most **vulnerable children and young people**, in particular those who have been orphaned, abandoned or at risk, by providing them with a safe and stable environment in which to live, grow, stay healthy, access **education** or **vocational training** and gain essential **life skills**.

Our goal is to empower a new generation of Tanzanians to become **engaged, globally aware** and **financially independent** citizens with the means to become change-makers in their own communities and the country at large.

Nearly 5 years on, the charity, alongside its partners, operates services from **8 different locations** across Kilimanjaro Region, employs **25 staff**, sponsors over **200** students and benefits nearly **10,000** children, young people and their families in the wider community each year.

Until recently, Kijana Kwanza has primarily focused on supporting children and young people aged 13-25 years. **Halima Children's Home** represents a **major expansion** of our work in supporting a new age demographic of 5-12 years, whilst challenging **outdated** modes of child welfare provision in Tanzania, and the developing world in general.

For **more information** about our work, visit kijana-kwanza.org.



The Problem

There are an estimated **1,300,000** orphans and **437,000** street children in Tanzania.

As a result, legally registered orphanages and children's homes are **severely overcrowded** and struggling to absorb the numbers.

This has led to the proliferation of **unregistered** establishments where vulnerable children **live in squalor** and are often subject to exploitation and **abuse**.



Background: Who was Halima Selengia?

Halima Selengia was a **founding member** of the Moshi Branch of the **Tanganyika African National Union (TANU)**. Set up in 1954, it was the principle political party in the struggle for sovereignty of the East African state of Tanganyika (now Tanzania).

Due to Selengia's activism, the Moshi Branch of TANU was **dominated by women traders** who contributed financially to the independence movement. On a visit to Kilimanjaro Region, **Mwalimu Julius Nyerere**, the founding father of modern Tanzania, resided at Halima Selengia's home.

In her final years, Halima Selengia **opened her home** to provide and care for orphaned children in the community. She died at the ripe age of **94 years**.

After her death, community members **continued her legacy** by caring for orphans, in the same property, establishing **Halima Orphanage**.



1919-2013

Eviction of Halima Orphanage

In April 2023, following a **dispute** between the heirs of **Halima Selengia**, the premises occupied by the orphanage, were, without warning, **repossessed by court order**.

Twenty children returned from school, to find their home **bolted shut** and bailiffs casting **their few possessions** into **dump trucks** stationed on the curb side.





Kijana Kwanza **responded to the emergency** immediately, arriving on the scene to salvage any remaining property and furniture. Despite **limited bed capacity**, the children were taken into our shelter, following a formal request by Moshi Municipality.

Kijana Kwanza has now **taken over management of Halima Orphanage**. The children currently reside in a renovated rented property with qualified staff overseeing their care. Whilst the older children have **moved to Kariwa Shelter**, which is more suitable for teenagers, they have been replaced by other primary school children, rescued from **abandonment, abuse and neglect**.

Halima Children's Home

An architectural rendering of a modern, multi-story residential building complex. The buildings are light grey with blue and yellow accents on the windows and doors. They are arranged around a central courtyard. In the foreground, there is a paved area with a yellow swing set, a small table with chairs, and a wooden climbing frame. The background shows green trees and a clear sky.

A New Start

Kijana Kwanza is now embarking on a major new project to **reinvent the welfare model for orphaned and abandoned children**. Inspired by the compassionate values of Halima Selengia, the new facility will be renamed **Halima Children's Home**.

Project Aims

Halima Children's Home will:

1. **Rescue** and provide emergency shelter for up to 120 children aged 5-12 years, **at any one time**, who have been orphaned, abandoned or subject to neglect or abuse.
2. **Meet** both the immediate and long-term physical, mental, emotional and social needs of vulnerable children including healthcare, quality schooling, and recreational activities.
3. **Support** family reunification, where possible, to avoid institutionalising children for the full duration of their childhood.
4. **Train** new foster parents to provide long-term community-based placements for children without family to care for them.
5. **Develop** neighbourly support networks that enrich the lives of children and create stable families.



Project Values

- ***Child First Approach:***

We will prioritise the needs of children above all else, and involve them, where possible, in all decisions that affect them and their futures.

- ***Community Based Care:***

We will restrict institutional care to emergencies and short-term interventions, encouraging long-term support from within the community.

- ***Culturally Sensitive:***

We will ensure that our model of child upbringing and fostering reflects the Tanzanian tradition of local people cooperating and working together to provide for the essentials and basics of good living.

- ***Holistic Community Development:***

We will seek to transform the lives of vulnerable children by making long-term investments in families and communities to challenge ingrained, structural inequalities in society.

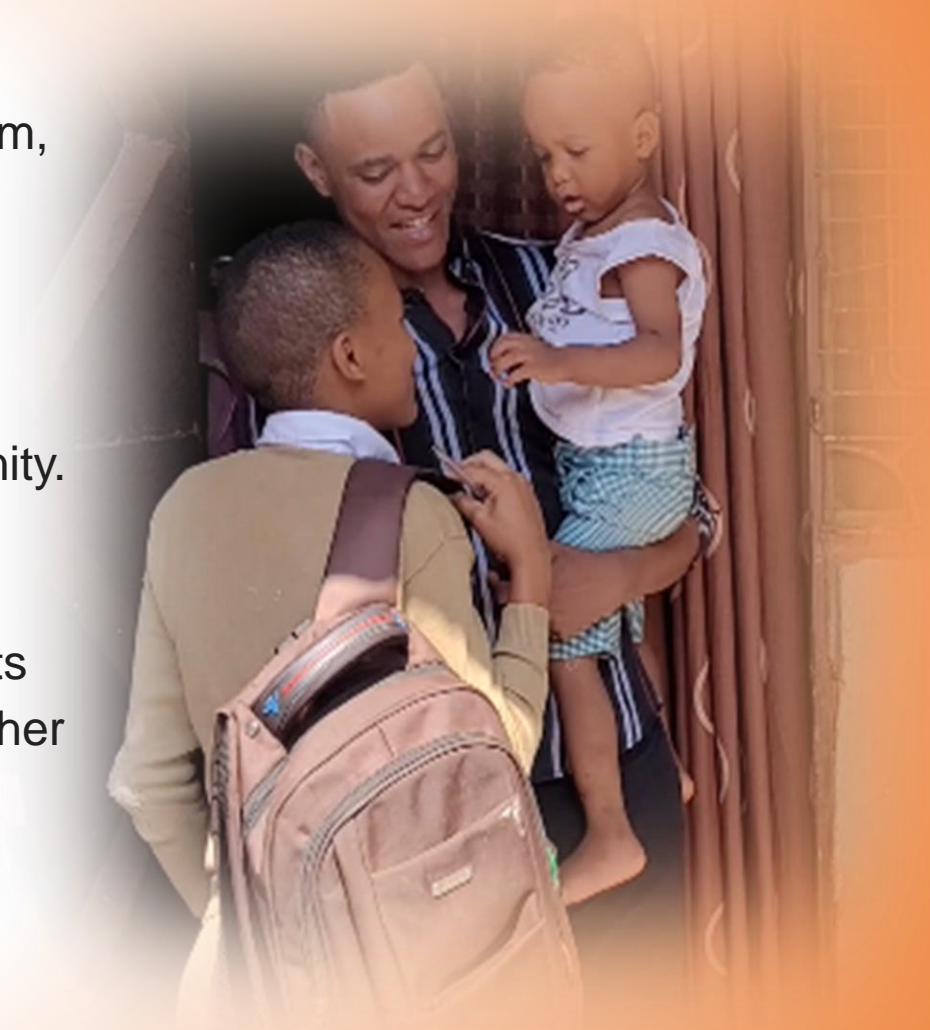



Roadside Kiosks
for Rent

First Floor:
Boys Dorm

Site Entrance

Ground Floor:
Staff Offices &
Children's Play Zones

Ground Floor:
Kitchen, Dining &
Prayer Rooms

Ground Floor:
Classrooms, Events Space
& Computer Room

First Floor:
Girls Dorm

Adventure
Playground

First Floor:
Staff & Volunteer
Accommodation

Facilities

- Male/Female Dormitories with a total capacity to shelter up to 120 children
- Staff & Volunteer Accommodation
- Offices, Boardroom & Private Consultation Rooms
- Classrooms
- Computer Room
- Library
- Locker Room
- Play Zone
- Kitchen Facilities
- Dining Room
- Prayer Room
- Outdoor Adventure Playground
- Roadside Kiosks for Income Generation

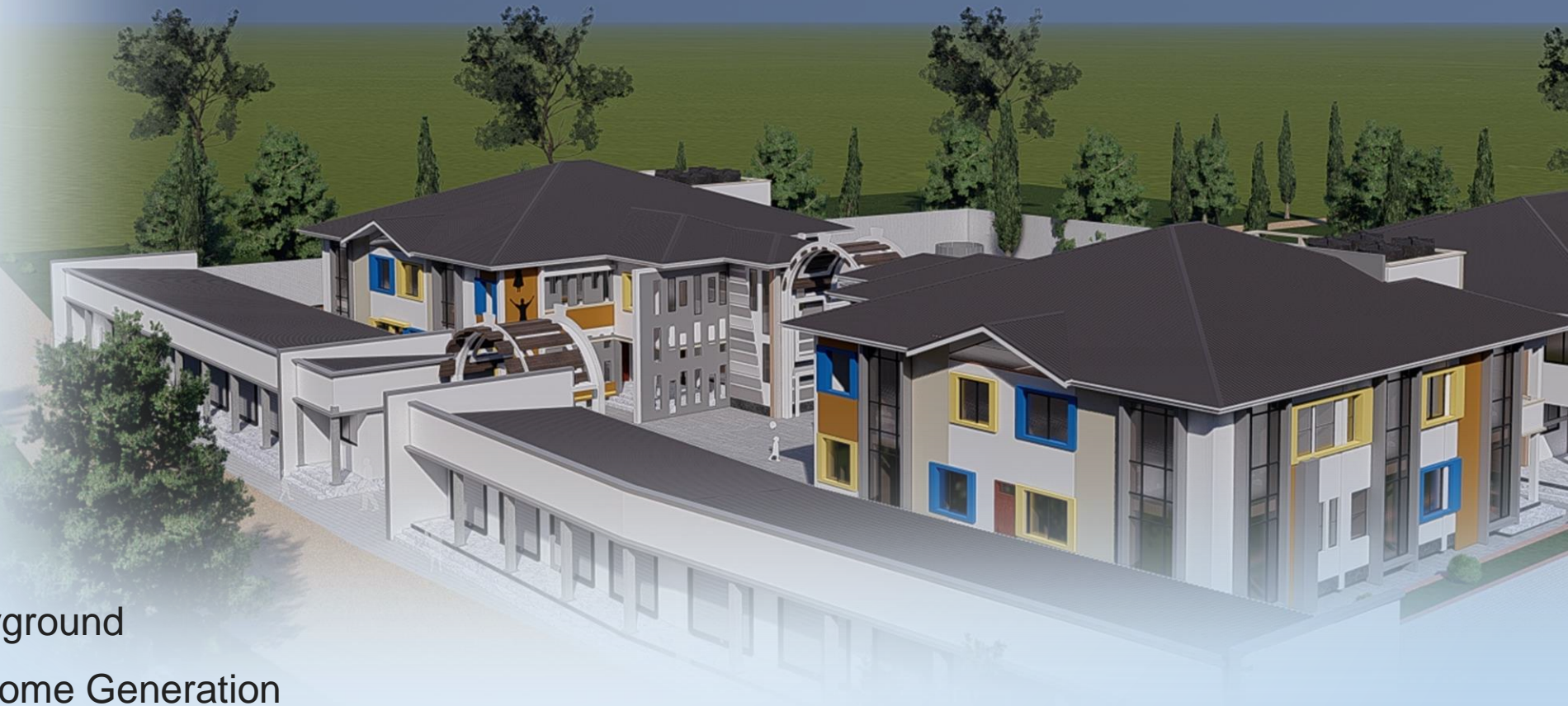

Intervention Model

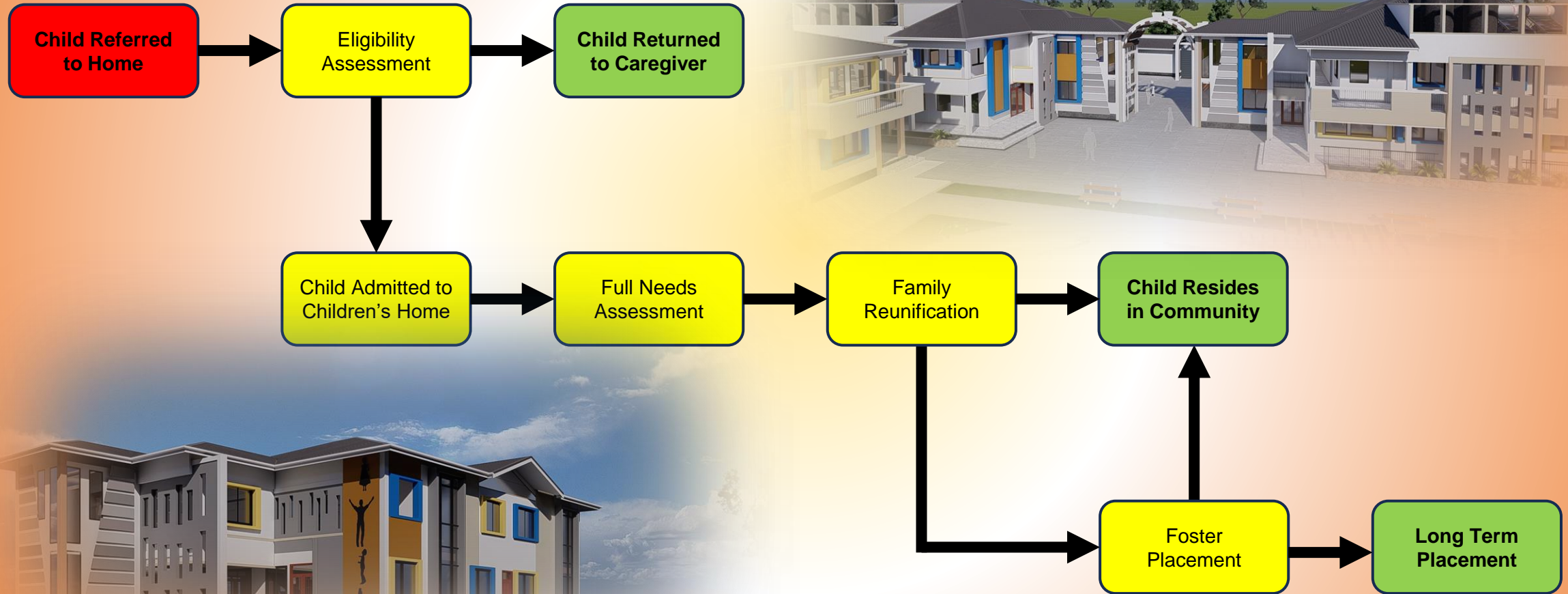

Halima Children's Home

Artist's Sketch of Residential Block



What is Community-Based Care?

Rescued children who have been transferred for long-term care in the community, will be provided with:

- **School fees** and all related education costs
- A monthly **care package** of food and toiletries
- **Medical insurance**
- **Clothing** and other personal items
- Access to weekend **extra-curricular activities** and regular **community events** at Halima Children's Home
- Pocket money deposited into a **child savings account**, which can be accessed after the child reaches the age of 18 years

Foster Families will receive:

- Regular **training** on child development and parenting skills
- Scheduled and surprise **safeguarding visits** from a social worker
- A **monthly payment** for the care of the child



Safeguarding

Protecting children from abuse and neglect is our number one priority.

All **staff and foster parents** will be required to:

- Undertake a **criminal record** check via local police
- Attend **safeguarding training** to understand the rights of children and their duties and responsibilities to children in care
- **Report any concerns** related to the welfare of a child to our local Safeguarding Officer as a condition of employment

Children will be provided with:

- **Age-appropriate training** in safeguarding
- Guidance on how to **report** any worries or concerns
- Access to a qualified Social Worker **on-call 24/7**



Halima Children's Home

Side View of Full Complex



Project Management

PHASE 1 (2023) = £50,000/\$70,000

Construction of Boundary Wall

PHASE 2 (2024) = £350,000/\$465,000

Construction of Residential Blocks, Staff Areas, Classrooms & Play Zones

PHASE 3 (2024-2025) = £200,000/\$260,000

Construction of Dining Block, Prayer Areas and Staff Accommodation

PHASE 4 (2025) = £100,000/\$130,000

Construction of Kiosks & Adventure Playground

PHASE 5 (2025) = £50,000/\$70,000

Paving & Garden Area

Total Project Cost: £750,000/\$995,000



Sponsorship Packages

Project Partners:

Contribution: £100,000/\$130,000 (match-funding)

Partner donations will be offered on a match-funding basis, introduced with maximum publicity at major project milestones. Partner logos will be displayed at the entrance of Halima Children’s Home.

Small & Medium Size Enterprises (SMEs)

Logos will be displayed in the Reception Area of Halima Children’s Home.

- Platinum:** £10,000/\$13,000
- Gold:** £5,000/\$6,500
- Silver:** £2,500/\$3,250
- Bronze:** £1,000/\$1,300

Room Sponsors:

A plaque will be placed at the entrance of the sponsored room in your name or a loved one.

Dormitory × 12	£10,000/\$13,000
Kitchen × 1	£25,000/\$32,500
Dining Area × 1	£25,000/\$32,500
Play Zone × 2	£25,000/\$32,500
Adventure Playground × 1	£50,000/\$65,000
Prayer Room × 1	£50,000/\$65,000
Classroom × 2	£20,000/\$26,000
Locker Room × 2	£5,000/\$6,500
Kiosk × 20	£3,000/\$3,900
Counselling/First Aid Room × 2	£10,000/\$13,000

How can YOU help?

1. **Join** our WhatsApp group at <http://bit.ly/3PNu16j> to volunteer and receive weekly updates on the project.
2. **Pledge** to raise £500/\$700 for Halima Children's Home.
3. **Recruit** 3 friends, colleagues or family members to also raise £500/\$700 for Halima Children's Home in the next 12 months.
4. **Share** our social media posts, messages and appeals with your contacts.
5. **Introduce** us to potential corporate and individual sponsors.



Wall of Remembrance

Pay **tribute** to your loved ones by including their names on our **Wall of Remembrance** at Halima Children's Home for a donation of **£200/\$260**.

The **name** of your deceased relative or friend will be **displayed** on-site alongside their country of birth/death.



Donate

Online: kijana-kwanza.org/donate

BACS: Account Name: Kijana Kwanza (Young People First)

Sort Code: 20-92-63

Account Number: 03806030

SWIFT/BIC: BUKBGB22

IBAN: GB05BUKB20926303806030

For more information:

Mohammed S Mamdani

mohammed@kijana-kwanza.org

UK Director of Kijana Kwanza

(based in Moshi, Tanzania)

WhatsApp: +44 7903 986 022

Gift Aid: If you are a UK taxpayer, please complete a Gift Aid Declaration at kijana-kwanza.org/giftaid to increase your donation by 25% at no cost to you.

UK Registered Charity: 1183099

Registered NGO in Tanzania: I-NGO/R/0602

Last Updated: 22 September 2023

Version 1.4

